

Project Management Initials : Designer : OB Checked : PB Approved : BW

Last saved by: MARIA.BORRELLAGARRID(2021-09-03) Last Plotted: 2021-09-03
Filename: \\IEDBL2FP001\EU\AECOM\NET\COM\DATA\DCS\PROJECTS\BP\60641561_PROJECT_CIRRUS\900_CAD_GIS\910_CAD\PLANNING FOLDER\R3\60641561-DWG-723.DWG

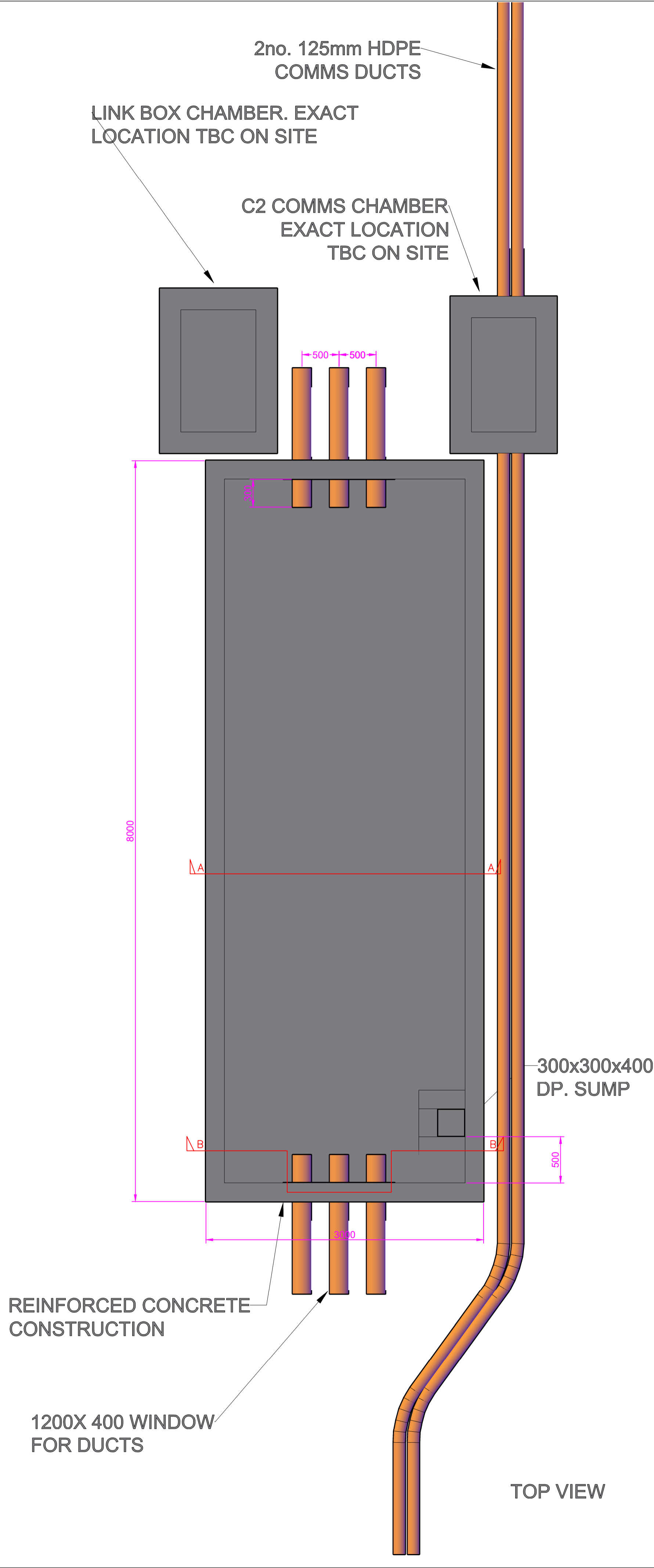

External Surface

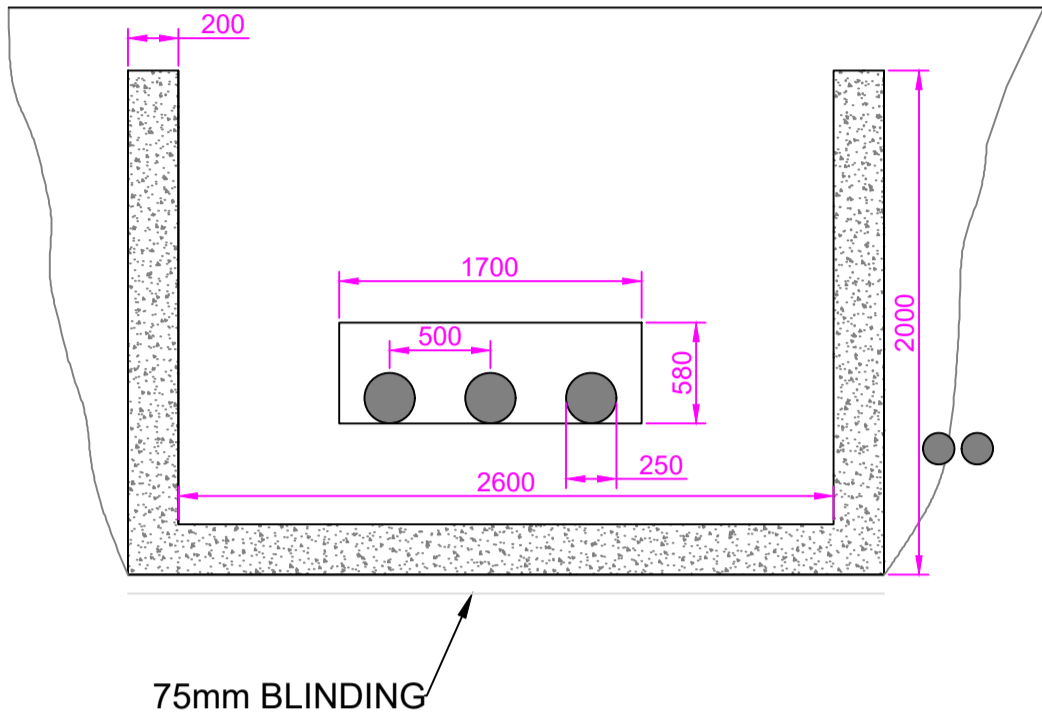

Section Cut A-A

External Surface

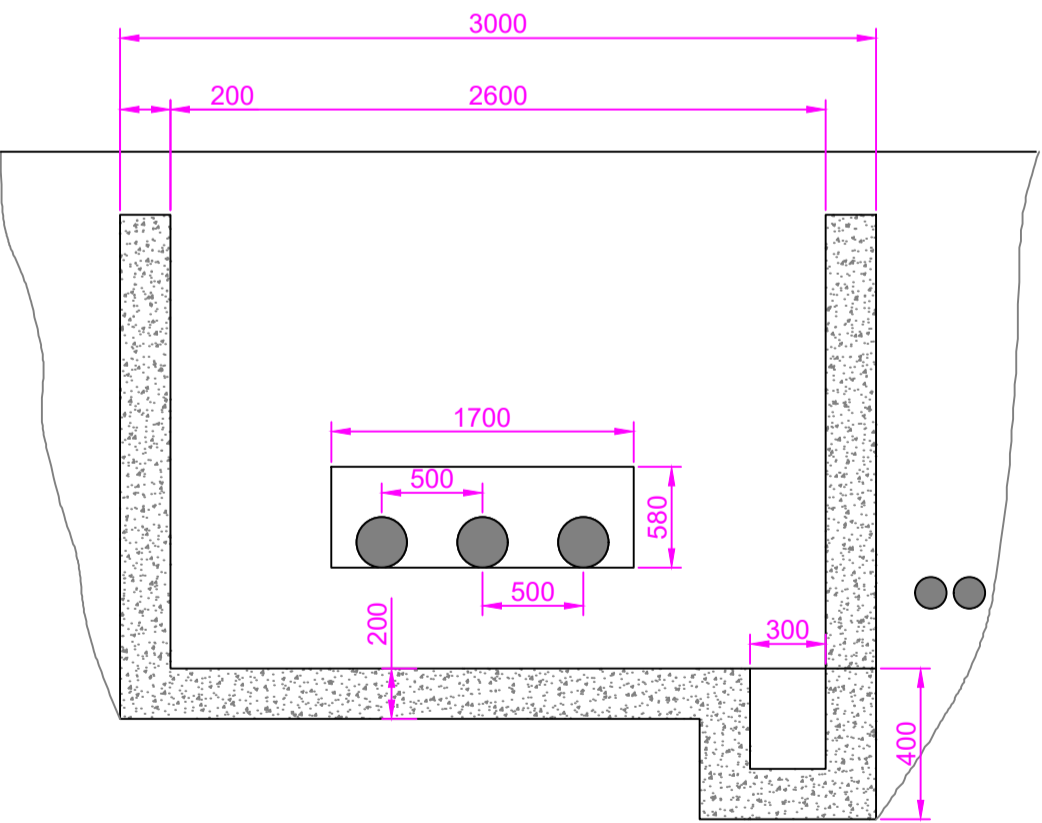

Section Jog B-B

CROSS SECTION 3 - TYPICAL JOINT BAY DETAIL - SEE SHEET 60641561 - DWG-721 - LAYOUT

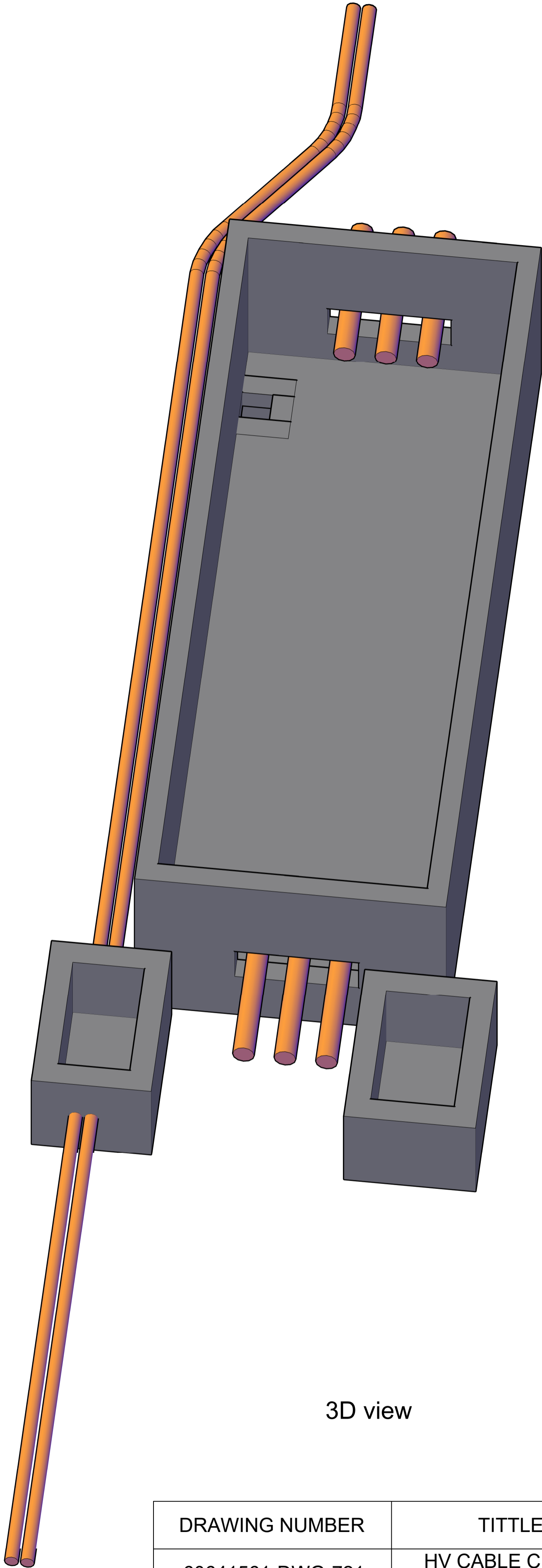

3D view

DRAWING NUMBER	TITTLE
60641561-DWG-721	HV CABLE CROSS SECTIONS-LAYOUT
60641561-DWG-722	CROSS SECTIONS 1 & 2
60641561-DWG-723	CROSS SECTION 3
60641561-DWG-731	CROSS SECTION 4

AECOM

PROJECT CIRRUS

CLIENT

HUNSTOWN POWER COMPANY LTD.

energía

CONSULTANT

AECOM
Adelphi Plaza
Georges Street Upper
Dun Laoghaire
County Dublin
Ireland
T +353 (0)1 2383100
www.aecom.com

NOTES

- DRAWINGS ARE INDICATIVE ONLY AND SHOULD NOT BE USED FOR DETAILED DESIGN;
- ONE SET OF DUCTS PER JOINT BAY;
- THIS DRAWING IS TO BE READ IN CONJUNCTION WITH ALL RELEVANT ENGINEERS, ARCHITECTS & ESB DRAWINGS;
- DRAWING IS BASED ON ESB DRAWING REFERENCE PE424-D7001-023-002-000.

ISSUE/REVISION

ISSUE/REVISION	DATE	DESCRIPTION
P3	03/09/2021	FOR PLANNING
P2	30/07/2021	REVISED COMMENTS
P1	28/06/2021	FOR PLANNING
P0	04/06/2021	FIRST ISSUE FOR PLANNING
I/R	DATE	DESCRIPTION

STATUS

FOR PLANNING

PROJECT NUMBER SCALE

60641561 1:30 @ A1

SHEET TITLE

MOORETOWN 220kV SUBSTATION
HV CABLE CROSS SECTION 3
SHEET 3 OF 4
TYPICAL JOINT BAY DETAILS

SHEET NUMBER REV

60641561-DWG-723 P3